

ALL IDEAS, DESIGNS, ARRANGEMENTS, AND PLANS INDICATED OR REPRESENTED BY THIS DRAWING ARE OWNED BY, AND THE PROPERTY OF RAMOS ARCHITECTS & ASSO. AND WERE CREATED, EVOLVED AND DEVELOPED FOR USE ON, AND IN CONNECTION WITH THE SPECIFIC PROJECT. NONE OF SUCH IDEAS, DESIGNS, ARRANGEMENTS OR PLANS SHALL BE USED BY OR DISCLOSED TO ANY PERSON, FIRM OR CORPORATION FOR ANY PURPOSE WHATSOEVER WITHOUT THE WRITTEN PERMISSION OF RAMOS ARCHITECTS & ASSOCIATES. WRITTEN DIMENSIONS OF THESE DRAWINGS SHALL HAVE PRECEDENCE OVER SCALED DIMENSIONS. CONTRACTORS SHALL VERIFY, AND BE RESPONSIBLE FOR ALL DIMENSIONS AND CONDITIONS ON THE JOB AND THIS OFFICE MUST BE NOTIFIED OF ANY VARIATIONS FROM THE DIMENSIONS AND CONDITIONS SHOWN BY THESE DRAWINGS. SHOP DETAILS MUST BE SUBMITTED TO THIS OFFICE FOR APPROVAL BEFORE PROCEEDING WITH FABRICATION. ALL RIGHTS RESERVED © 2024.

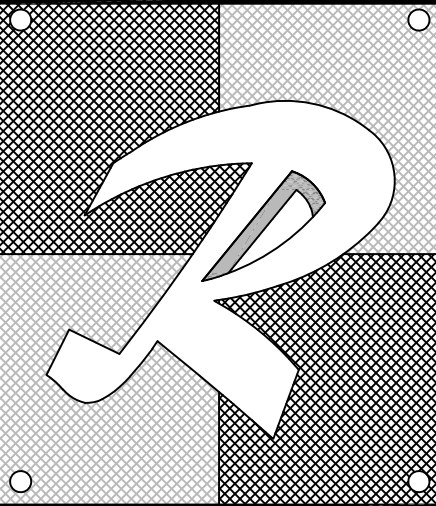

PROPOSED BLDG. ADDITION & PARKING FOR:
50 S.W. 5TH STREET
50 S.W. 5TH STREET POMPANO BEACH, FL 33060
Ramos Architects & Associates
780 TAMiami CANAL ROAD MIAMI, FL 33144 ■ (305) 506-7388

SEAL:

ARCHITECT OF RECORD
JOSE RAMOS | FLA. REG. AR11115 | AAC1595

DATE: 07/09/25

| |
|--|
| |
| |
| |
| |
| |
| |
| |
| |
| |
| |

| | |
|----------------|-------|
| PROJECT NUMBER | 24151 |
| SHEET | LS |

LIFE SAFETY FIXTURE LEGEND

- EMERGENCY LIGHT
- EXIT SIGN
- EXIT / EMERGENCY LIGHT COMBO
- DIRECTIONAL EXIT SIGN
- E EXISTING TO REMAIN
- N NEW

EXIT SIGNS MUST BE ELECTRIC WITH BATTERY BACK-UP
EXIT SIGNS & EMERGENCY LIGHTS WITH BATTERY BACKUP
RATED FOR 90 MIN.

ACCORDING TO THE FLORIDA FIRE PREVENTION CODE
NFPA 101: SECTION 42 TABLE 42.2.5 AND 42.2.6.

OCCUPANCY INDUSTRIAL:

COMMON PATH..... 50 FEET
DEAD END..... 50 FEET
TRAVEL DISTANCE..... 200 FEET

OCCUPANCY BUSINESS:

COMMON PATH..... 75 FEET
DEAD END..... 20 FEET
TRAVEL DISTANCE..... 100 FEET

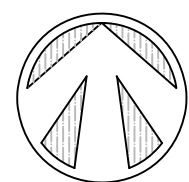
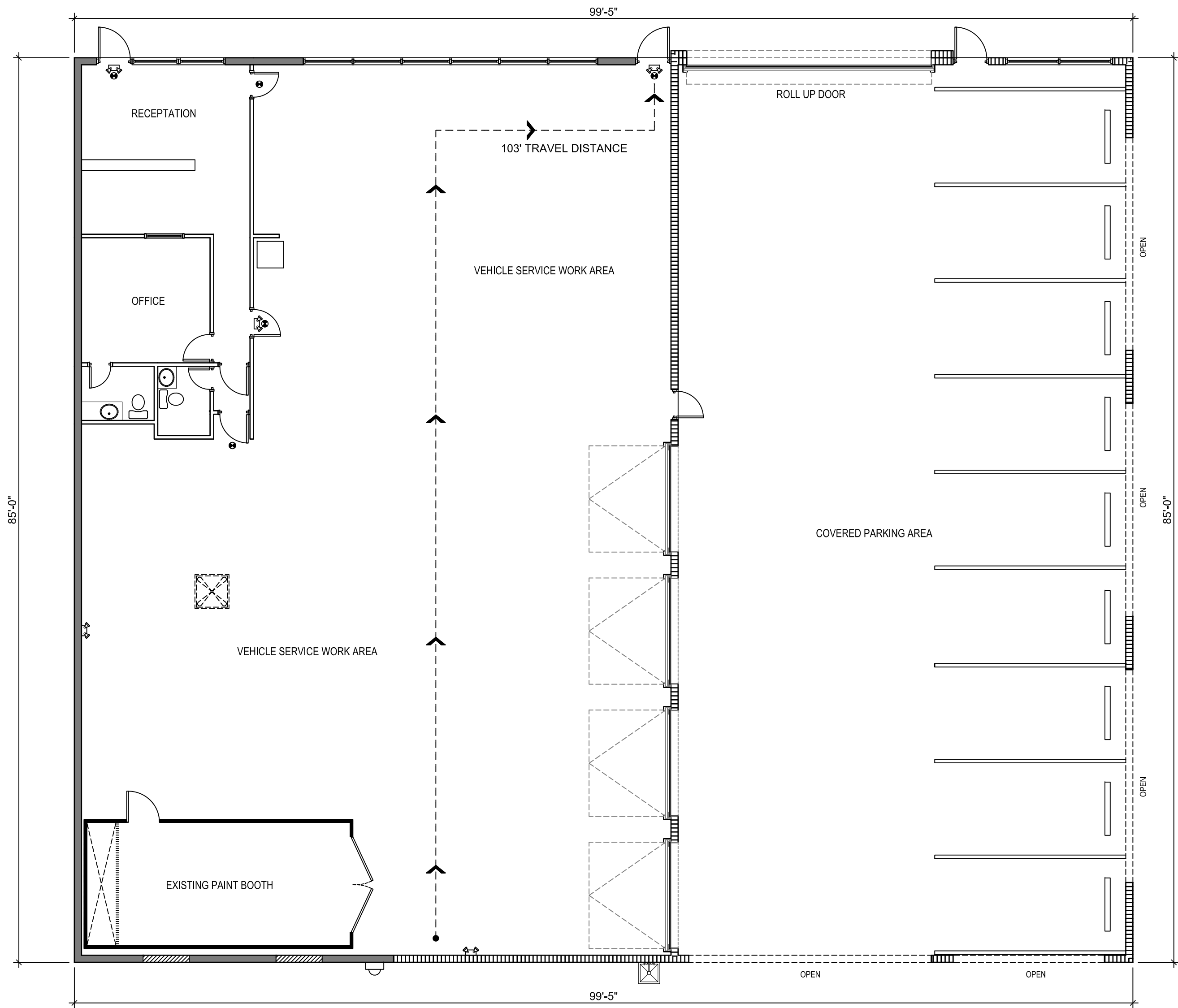

PROPOSED LIFE SAFETY PLAN

SCALE: 1/8" = 1'-0"

DRC

PZ25-12000015

08/06/2025